



# STEP 2: CHOOSE YOUR TENT

# TOURING SERIES

Patent Application 2016100958

**Full setup 3minutes**



## 'Under 3 minutes, under a million stars'

The camper trailer has been re-imagined. We don't believe a quick set up camper trailer should be based on compromise. With a market that is flooded with "touring style" camper trailers, we boldly redesigned how the conventional camper is used. Why should you sleep on an undersized foam mattress & sacrifice the comforts, or have to leave the bikes, boats and outboards behind just to save time when you set up? With the Touring Series, you can have all this.

With strict criteria from both our sales representatives and customers seeking maximum comfort and storage with a minimum effort set up, our design team got to work. Our patented tent and awning design paired perfectly with our comfortable features and limitless storage on our Safari & Safari Extenda range.

The Touring Series tent can be set up for a quick stay after a long day on the tracks, for the whole family or anywhere in between due to its modular design in under 3 minutes. The quick setup is owing to the patented pole system for the tent and awning, this design eliminates the need to attach any further poles to support the canvas. It's as simple as extending the poles into the correct position and using the 2 quick clip guy ropes to anchor it down. Instead of following the trend of a detached kids room, we fitted the tent with separate walls and floor that attach to the main tent frame allowing you to set up as little or as much as you want adding privacy or protection from weather.

### Specs

- Australian Wax Converters Dynaproofed canvas
- 6.5' x 7' (Safari) 6.5' x 9' (Safari Extenda) floor area
- 8' attached awning with patented pole design – All awning poles fold away with tent
- Roll up kitchen wall
- Drop down privacy screen
- 5 large full length windows with canvas flaps on inside
- 2 x lower wall vents to maximise airflow
- Zip access to mudguard box
- Unique zip gutter design provides excellent water ingress protection
- Bucket style zip in floor
- Unique internal pole design
- Removable modular walls & floor
- Fully sealed tonneau with 8 adjustable pulldown straps to minimise flapping & dust/water ingress
- Quality poles, pegs & ropes needed for complete set up
- All stainless-steel fittings on tent

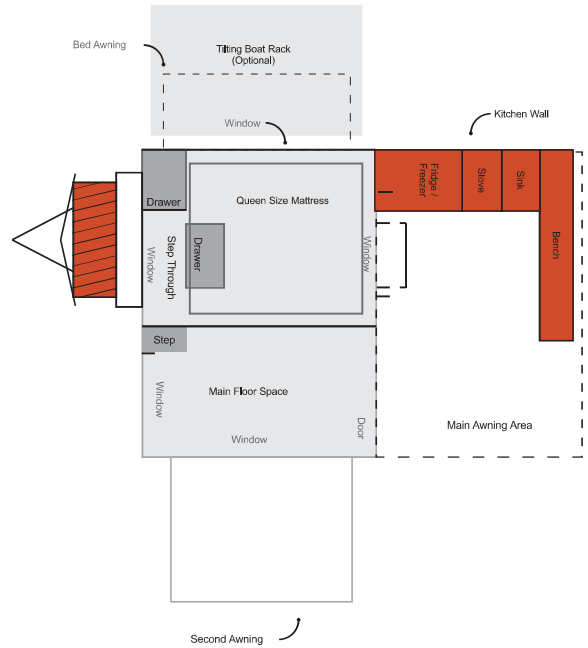

Scan here for more information